

LINTEC PRINTING MACHINE

LPM-300 **i**ITP



AR and IP Systems



LINTEC PRINTING MACHINE

LPM-300 iTP

- The ink supply volume is automatically controlled by AR software. High precision labels are not a problem.
- Quick printing set-up is offered. Best used for small lot and multi-type label printing.
- Computer-controlled operation does not require an experienced operator.

AR System (Area Reading System)

The special AR software system divides the target image data, which is the scanned data from negative, positive films, CIP3(1bit tiff data), etc., into eleven units and then calculates the graph pattern area rate. This calculated data is then saved for future references to reprint the same image.

The original image and visualized graphic patterns of the calculated results are simultaneously displayed in order to understand and to analyze the print data. Even an amateur can grasp the necessary information for image printing and is easily able to modify the image data via the computer.

The host computer can control multiple printing units and is also able to construct networks with external computers to promote on-line ink adjustment data sharing systems.

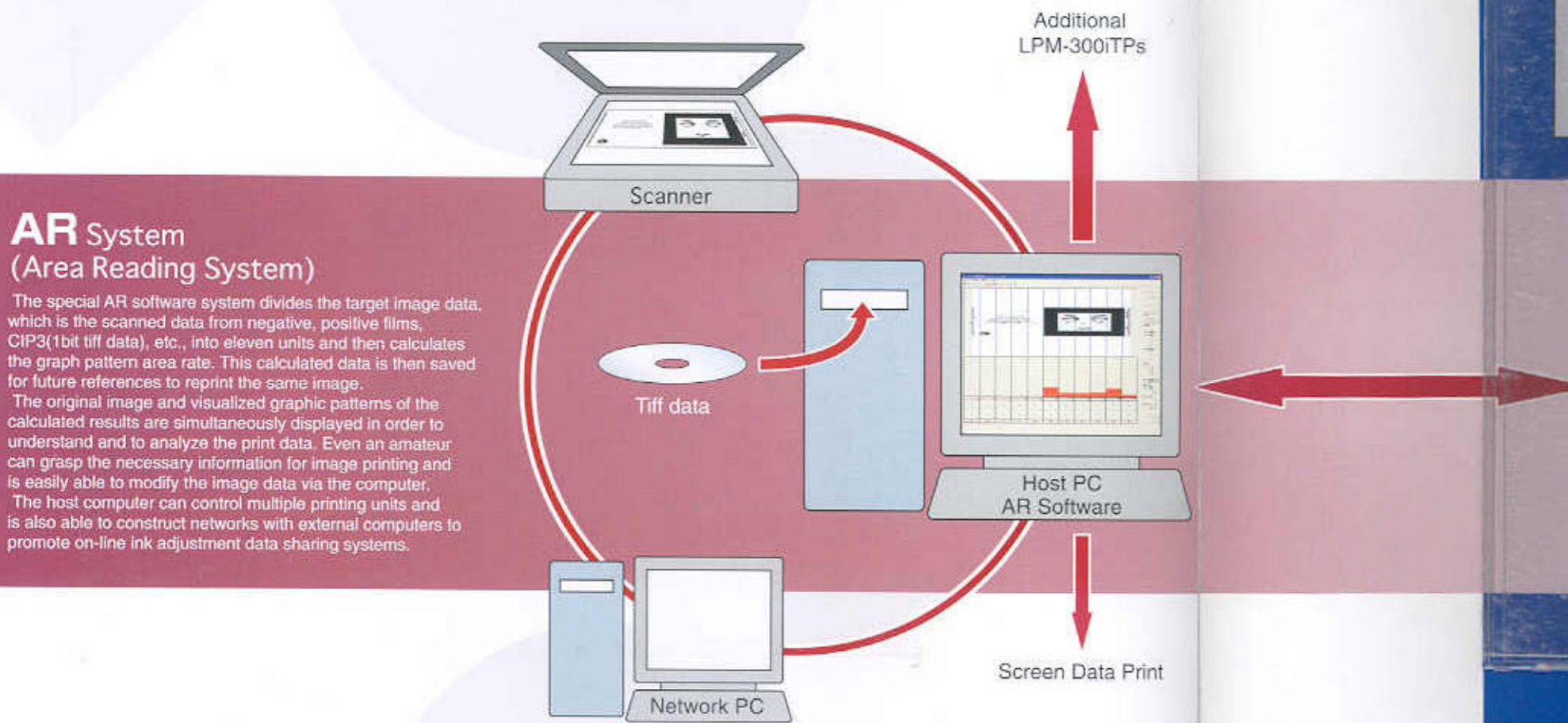

IP System (Computerized Ink Pre-set)

The data (graph pattern area rate) calculated by the AR System is loaded from the host computer and it precisely controls the ink supply volume via the Individual Ink Transfer Roller (Ductor Roller).

If necessary, it is possible to fine control the ink supply volume by increasing or decreasing the height of the graph bars via the up/down buttons on the touch panel screen.

Readjusted data is also saved to the host computer to facilitate reprinting of the same image data. This will drastically reduce the ink adjustment time for reprinting.

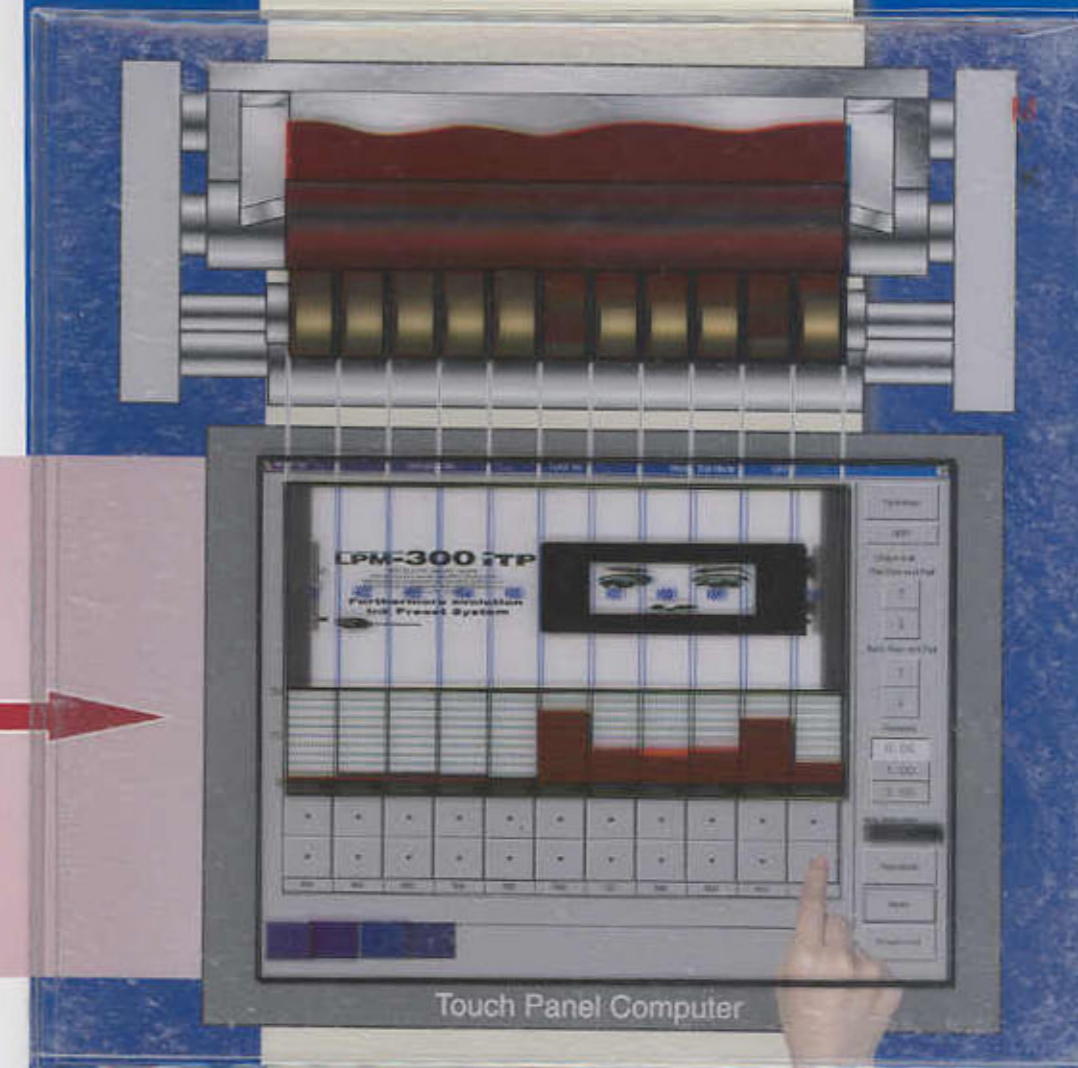

LPM-300 iTP

SPECIFICATIONS
 Maximum web width: 300mm
 Maximum printing width: 230mm
 Maximum repeat length: 240m
 Drive: UV laser

Furthermore evolution
 Ink Preset System



Advantages of introducing the LPM-300iTP (Comparison with conventional letterpress)

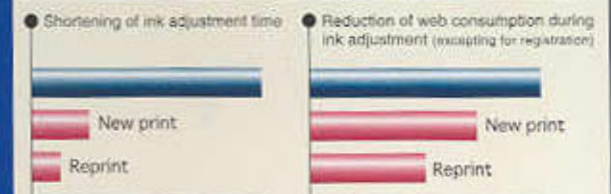

The LPM-300iTP has advantages not only of the aforementioned merits but also of printing speed, ink loss reduction, and improves total printing processes.

■ : Conventional letterpress ■ : LPM-300iTP

Dimensions:

Unit: mm

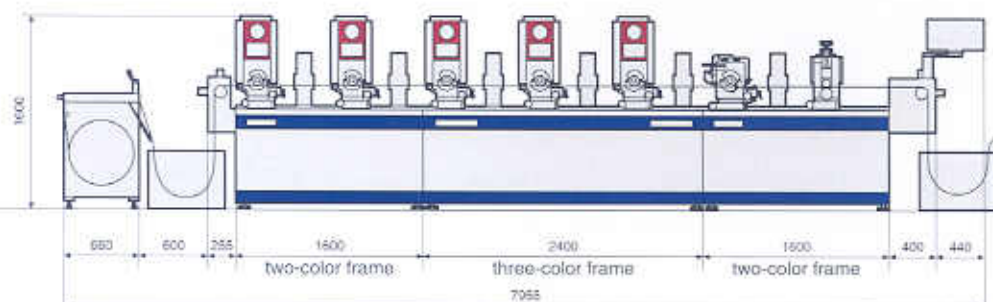

■ The LPM-300iTP is constructed with combinations of the two-color frame, three-color frame, and the optional in-line units.

Specifications:

Web Width	: 100 to 300mm
Maximum Printing Width	: 280mm
Repeat Length	: 50 to 245mm
Maximum Printing Speed	: 240 impressions./minute
Recommended Printing Speed	: 100 to 220 impressions./minute
Printing Colors	: 2 to 9 colors
Electric Power	: 200 volts/AC 3 phase, 50/60Hz 50A 17.3KVA
Compressed Air	: 0.5MPa 1.32L/minute per color

NOTE: Specifications and product design subject to change without notice.

Patents and Copyright of I.Mer Co.,Ltd.

Copyright of "AR software"(="AREA READING SYSTEM") belongs to I. Mer Co., Ltd. All rights to this software and rights concerning this software belong to I. Mer Co., Ltd.

"Individual Ink Transfer Roller"(="Ductor Roller") is patented by I. Mer Co., Ltd. (Japanese Patent No. 2866997 and No. 3008026, and other international patents.)

In-line Options:

- UV Varnishing Unit with UV Dryer
- In-line Laminating Unit
- Rotary Die-cutting Unit
- MG Type: The magnetic cylinder is installed in the printing unit.



LPM iTDH

Is a die-cutting machine with laminating and rewinding units. Furthermore, it can connect the hot-stamping and other optional units. The shaftless mechanism with independent drive units promotes smooth interface with the LPM-300iTP. It is also possible to run the machine independently simply as a high-speed die-cutting machine.

LPM iTDH Special Options:

- ◆ Hot-stamping unit
- ◆ Screen printing unit
- ◆ Numbering unit
- ◆ Punching unit

Specifications:

Web Width	: 100 to 300mm
Die-cutting feed length	: 20 to 245mm
Blade height	: 9.5mm
Machine speed	: 30 to 240 impressions./minute
Electric Power	: 200 volts/AC 3 phase, 50/60Hz 50A 17.3KVA



LINTEC Corporation

HEAD OFFICE 23-23 Honcho, Itabashi-ku, Tokyo 173-0001 Japan Tel. (03)5248-7777 Fax. (03)-5248-7756 URL. <http://www.lintec.co.jp>